

Assembly Instructions

<With Bracket>

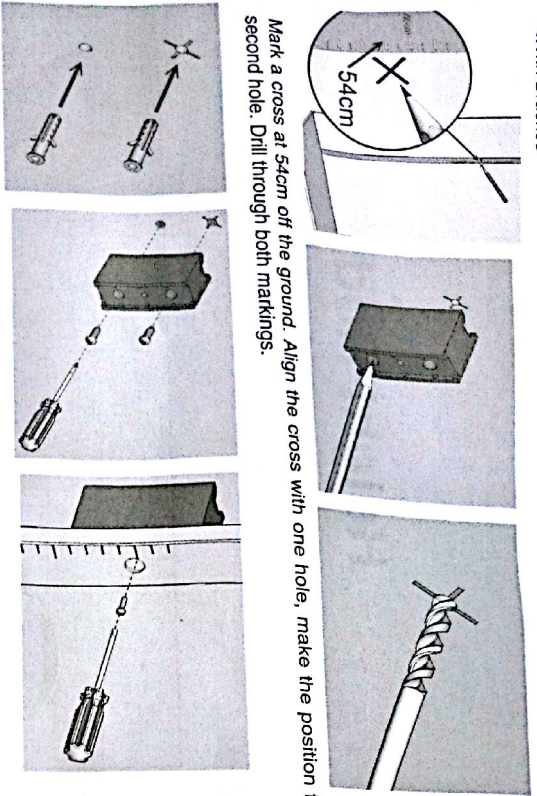

Mark a cross at 54cm off the ground. Align the cross with one hole, make the position for second hole. Drill through both markings.

Insert the plastic nails firmly. Screw bracket to the wall. Screw the height rod on the bracket.

<Without Bracket>

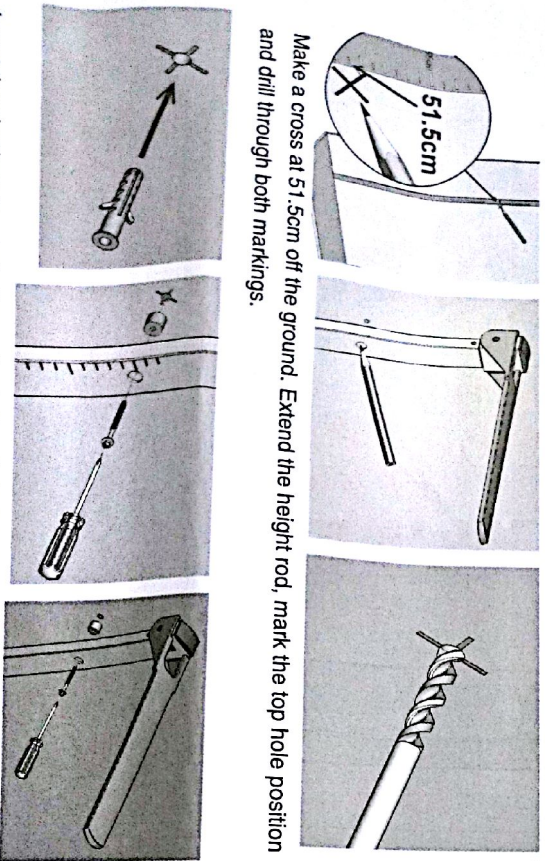

Make a cross at 51.5cm off the ground. Extend the height rod, mark the top hole position and drill through both markings.

Insert the plastic nails firmly. Screw the bottom hole first. Then screw the hole on the top.

Safety Instructions

Before using the new measuring rod, please take time to read the following safety instructions.

- Follow the operating instructions.
- Attach the measuring rod only to Charader column scale.
- Use the assembly material supplied.
- When assembling, ensure that screws are tight and that the rod has been assembled correctly (See chapter "Assembly instructions").
- "Assembly instructions").
- Fold down the measuring slide after height has been measured to avoid risk of injury.

How to use the height rod

Measuring over 131cm :

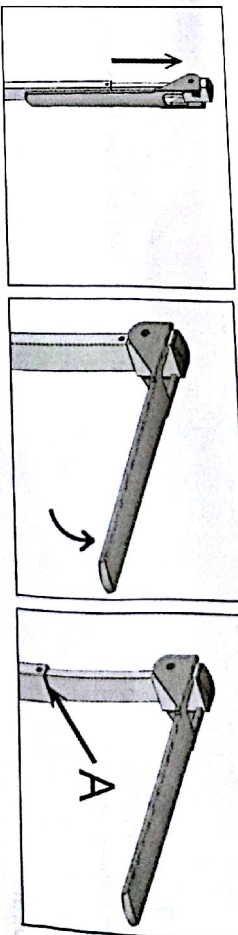

1. Pull out the rod
2. Position the plate to a horizontal position.
3. Measured result can be read off at (A).

Measuring under 130cm :

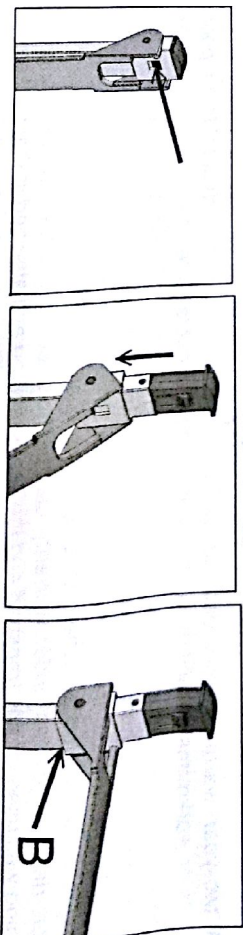

1. Fold the plate and press the tenon.
2. Pull down the plate while tenon is pressed.
3. Measured result can be read at (B).

Technical data

Measurement range: 60-200 cm / 24-78 inch

Graduations: 1mm / 1/8 inch

Dimensions

(W x H x D): 55 x 784 x 34 mm

Weight: ca.700 g

Temperature range: +10°C up to +40°C

Medical product in accordance with

Directive 93/42/EEC: Class I